

OWNERSHIP STATEMENT

I the undersigned, being all parties having any record title interest in the real property being subdivided, do hereby consent to the preparation and recordation of this Parcel Map. I also hereby dedicate to the public the 10 foot wide snow storage and drainage easements as so designated on this map. I also hereby dedicate to the public the 20 foot wide drainage/open space easement as so designated on this map.

As owner:

Michael J. Kartsonis
Michael J. Kartsonis, an unmarried man

State of California) ss.
County of ORANGE)
On this 5th day of DECEMBER, 2003 before me,
LOURDES S. DEVILLA
a Notary Public in and for said County and State, personally appeared

Michael J. Kartsonis

☐ personally known to me - OR - ☒ proved to me on the basis of satisfactory evidence to be the person(s) whose name(s) is/are subscribed to the within instrument and acknowledged to me that he/~~she/they~~ executed the same in his/~~her/their~~ authorized capacity(ies), and that by his/~~her/their~~ signature(s) on the instrument the person(s), or the entity upon behalf of which the person(s) acted, executed the instrument.

WITNESS my hand and (optional) official seal:

Louder S. Devilla Louder S. Devilla
Notary Public (sign and print name)
My commission expires: JULY 4, 2007
County of my principal place of business: ORANGE

C.C.&R.'s NOTE

The declarations of covenants, conditions, restrictions and reservations were recorded on Dec. 22, 2003, as Instrument No. 2003 013734 of Official Records on file in the office of the Mono County Recorder.

PLANNING COMMISSION'S CERTIFICATE

This parcel map, being in accord with the approved or conditionally approved tentative map, if any, is hereby approved by the Mono County Planning Commission.

12-11-03
Date

By: Rihad Kattuman
Chairman, Mono County Planning Commission

RECORDER'S CERTIFICATE

Filed this 22nd day of December, 2003, at 1:44 P.M., in Book 4 of Parcel Maps at page 138-138A, at the request of Michael J. Kartsonis

Renn Nolan
Mono County Recorder

By: Sherrin R. Hale
Deputy Mono County Recorder

Instrument No. 2003013733

Fee: \$10.00

CLERK TO THE BOARD'S STATEMENT

I hereby state that the Mono County Board of Supervisors, at a regular meeting thereof, held on the 12th day of December 2003 by an order duly passed and entered, did reject, on behalf of the public, those easements for snow storage and drainage purposes as shown on this map, and did also reject, on behalf of the public, that 20' wide easement for drainage/open space purposes, as shown on this map.

12/22/2003
Date

By: [Signature]
Clerk to the Board of Supervisors

SURVEYOR'S STATEMENT

This map was prepared by me or under my direction and is based upon a field survey in conformance with the requirements of the Subdivision Map Act and local ordinance at the request of Michael J. Kartsonis on December 1, 2003. I hereby state that this parcel map substantially conforms to the approved or conditionally approved tentative map, if any.

Dec 3 2003
Date

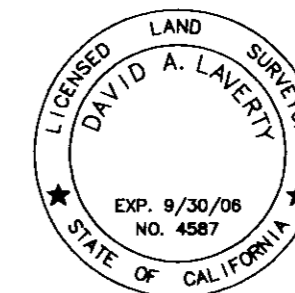

[Signature]
David A. Laverty, L.S. 4587
Lic. exp. 9/30/2006

TAX COLLECTOR'S CERTIFICATE

I hereby certify that, according to the records on file in this office, there are no liens against this subdivision, or any part thereof, for unpaid state, county, municipal, local taxes or special assessments collected as taxes, except taxes or special assessments not yet payable. Taxes or special assessments collected as taxes which are a lien but not yet payable are estimated to be in the amount of \$ 983.50 for which receipt of good and sufficient security conditioned upon payment of these taxes is hereby acknowledged.

Shirley A. Cranney
Mono County Tax Collector

12-10-2003
Date

By: Rosmary Hager
Deputy Mono County Tax Collector

SIGNATURE OMISSIONS

The signatures of the following companies, their successors and assigns, owners of easements as disclosed by the following deeds recorded in the Official Records of Mono County, have been omitted under the provisions of Section 66436 Subsection a-3Ai of the Subdivision Map Act:

Nevada California Power Company

"S"/479 O.R.

California Electric Power Company and
Interstate Telegraph Company

494/77 O.R.

COUNTY SURVEYOR'S STATEMENT

This map has been examined by me and the subdivision as shown is substantially the same as it appeared on the tentative map, and any approved alterations thereof. All provisions of the Subdivision Map Act and any local ordinances applicable at the time of approval of the tentative map have been complied with. I am satisfied that this map is technically correct.

Mono County Surveyor

12/19/03
Date

By: Richard Boardman
Richard Boardman L.S. 4686
Lic. exp. 09/30/05



PARCEL MAP NO. 34-56
IN THE UNINCORPORATED TERRITORY OF MONO COUNTY, CALIFORNIA

BEING A SUBDIVISION OF LOTS 7, 8, 15 AND 16 OF BLOCK 21 OF SILVER LAKE PINES TRACT NO. 2 AS PER MAP RECORDED IN BOOK 1 OF MAPS AT PAGE 8 IN THE OFFICE OF THE COUNTY RECORDER, COUNTY OF MONO, STATE OF CALIFORNIA.