

2013-2016 Ram Rearview Mirror Upgrade and Harness Install



Required Parts:

- RA2 style Manual Dim Mirror w/mics: - 68102484AA (AB, etc)
- Or 911/Assist AutoDimming Mirror (Sales Code & BCM edits Req'd): - 68096091AF
- Mirror Header harness: - 68207372AB
- Mirror Mount Covers (if Needed):
Upper - 1ZA38DX9AA
Lower - 1YW11DX9AA

❖ Entire kit at [OemAutoPartsCo \(RAM MIR\)](http://OemAutoPartsCo.com) or individual parts at online dealers (ie. www.allmoparparts.com)

Additional Notes & References:

- **Note1:** If you currently have a backup camera image in your existing mirror you will need to reroute the video feed to your radio display screen.
- **Note2:** If you currently have the roof mounted amber lights you will need to pin power and ground into your newly installed mirror cable.
- [Part 1/4: 2010-2015 Ram trucks A/C evaporator and recirculate housing](#) (MotorCityMechanic, 1:50 – 4:00)
- [Part 2/4: 2010-2015 Ram trucks A/C evaporator and recirculate housing](#) (MotorCityMechanic, 1:20 – 2:45)

1. Loosen one (1) 10mm bolt and disconnect negative battery cable

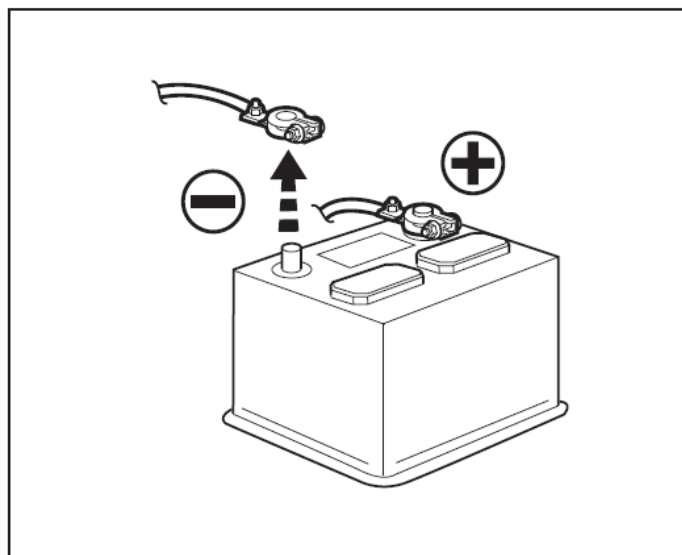

NOTE: Use caution when removing the mirror to not damage the windshield.

2. Remove the existing mirror (2) from the windshield by rotating mirror bracket counterclockwise to release from mounting button (1).

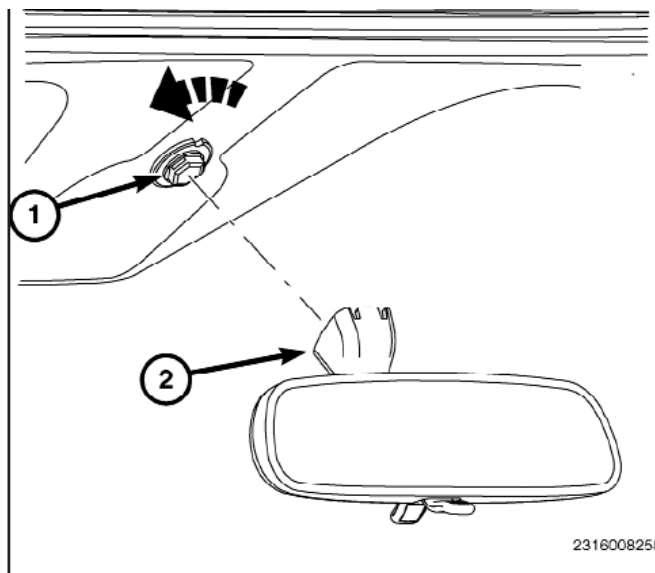

3. Position the new mirror (2) near the mounting location and align the indicator mark on the mirror bracket to the 12 o'clock position on the windshield mirror button (1).

Place mirror bracket over windshield button and rotate mirror assembly 60 degrees clockwise to attach to the windshield button. Rotate until a positive stop (detent) is felt.

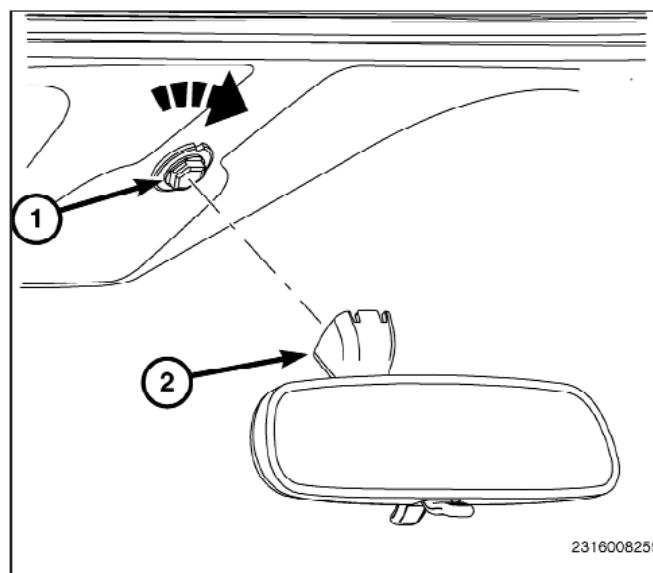

CAUTION! When removing or installing the screws (1), be certain to avoid any wiring or drain tube interference.

4. If equipped, disconnect the wire harness connector for the illuminated vanity mirror (4). Remove the three screws (1) that secure the passenger side sun visor (2) to the roof panel and remove the visor from the headliner (3).

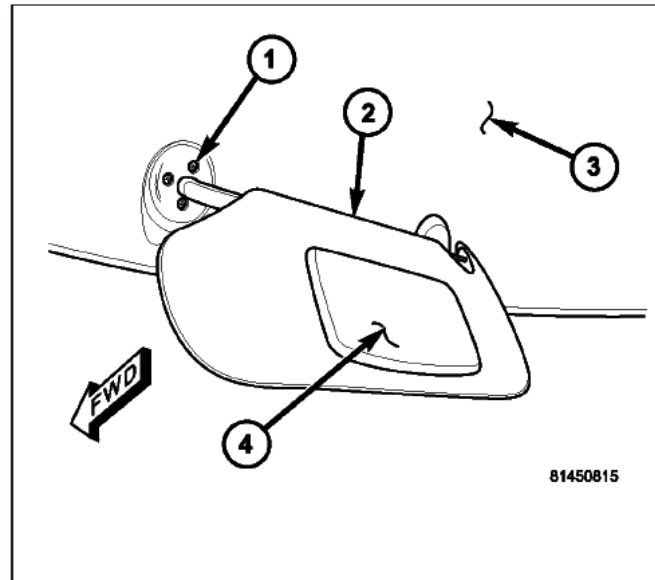

5. Disengage the fastener covers (2) from the passenger side A pillar (1). Remove the bolts from the A pillar and remove the A pillar.

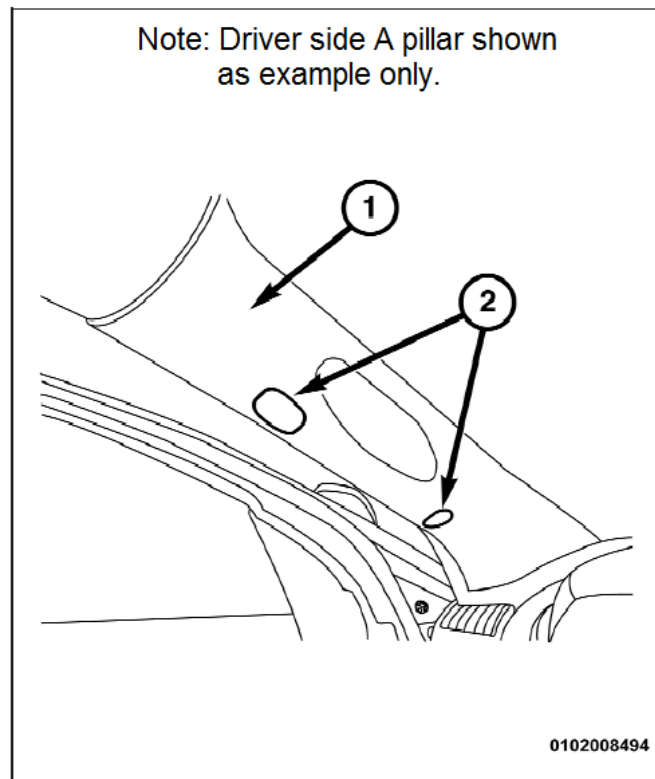

6. Using a trim stick or equivalent, from the notch on the bottom, remove the passenger side dash panel side cover (1).

Note: It may also be helpful to remove the upper/lower glovebox and passenger side air vent

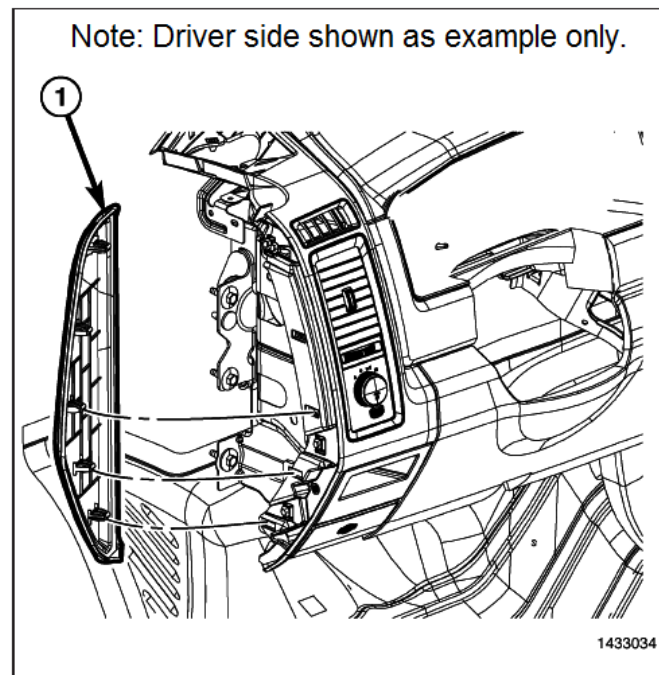

Lower Glovebox release



HVAC Module Passenger Side dash cover

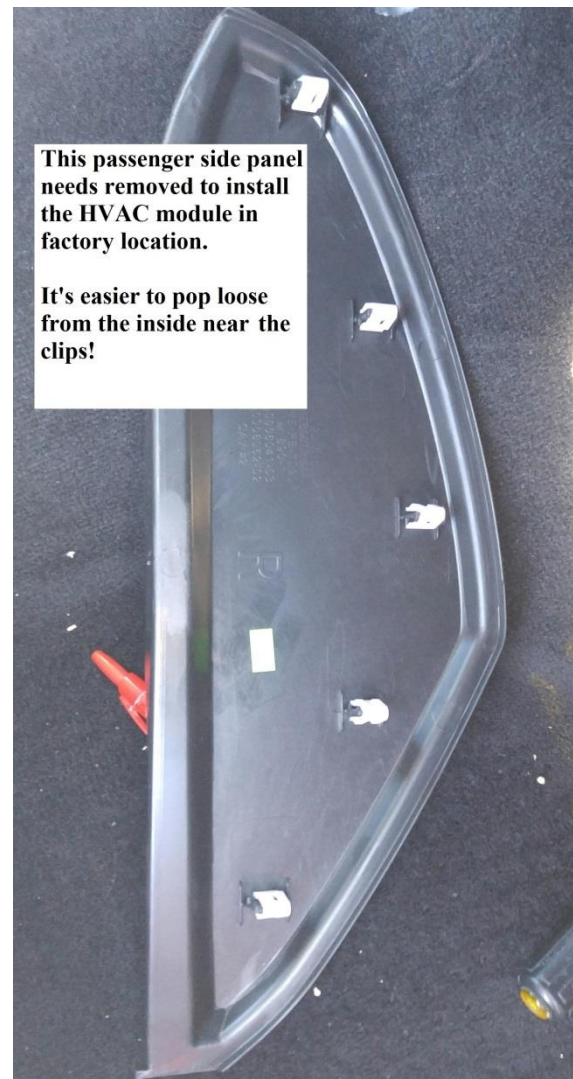

7. Connect 10 way connector (1) into mirror assembly.
Place lower cover (2) directly under mirror and push up to install on mirror (3).
As shown in the graphic, install upper cover (4).

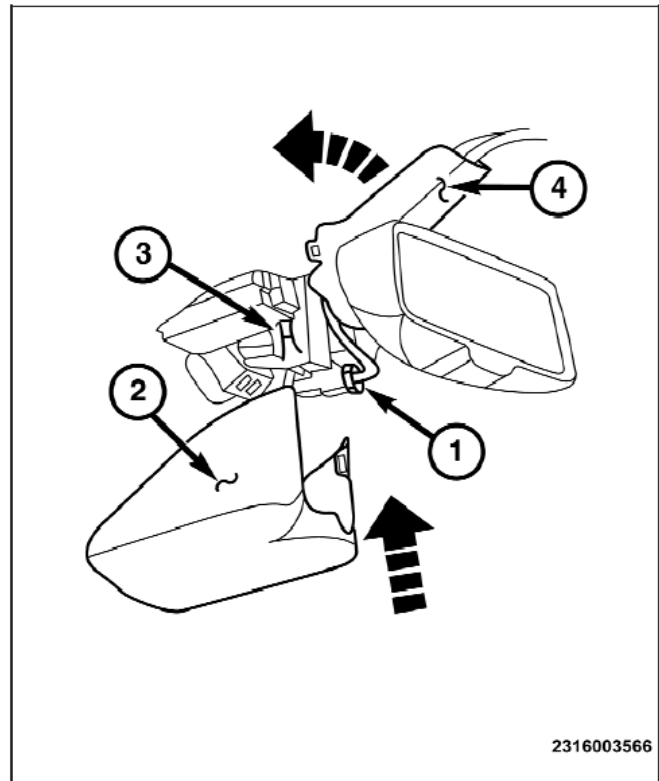

8. Route mirror harness (1) from the rearview mirror along the windshield and down the passenger side A-pillar to the kick panel.

Secure the mirror harness to the existing A-Pillar harness every 6-8 inches with tie straps.

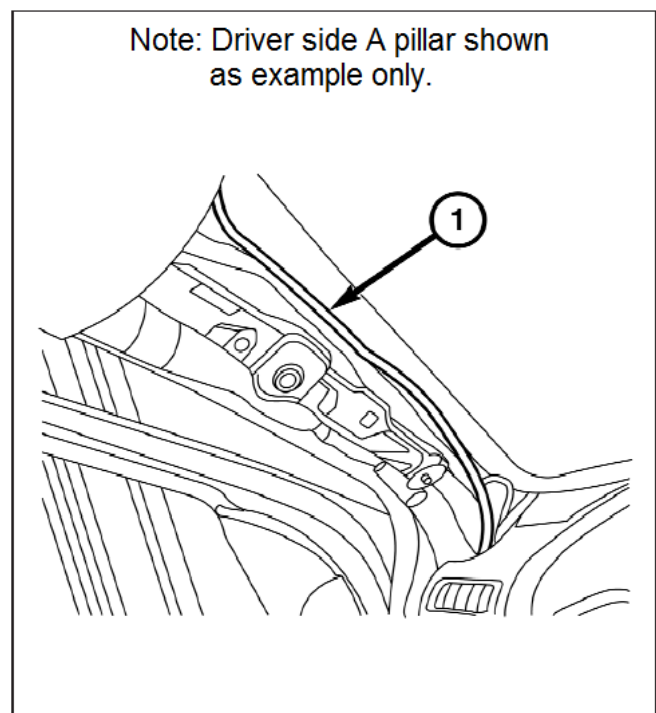

9. Plug the mirror harness into the matching connector just above the passenger side kick panel and behind/just below the passenger side air vent.



10. Reinstall previously removed parts and reconnect battery.